



INDUSTRIAL CLUTCHES

APPLICATIONS

**Industrial Equipment; Pumps, Sprayers,
Cement Finishing Equipment, Floor Polishers,
Small Chippers, Compressors**

INDUSTRIAL CLUTCH FEATURES

Cast Iron Pulley, Straight Centrifugal Clutch.
Use the Industrial Clutch for
4-Cycle Engines to 8 H.P.

SHOES: Long wearing, smooth engaging,
organic material. Quiet.

BEARINGS: Double sealed roller type,
precision ground and packed with
hi-temperature grease.

DRUM/PULLEY: One piece cast iron
construction for rugged durability.



SCP-IC

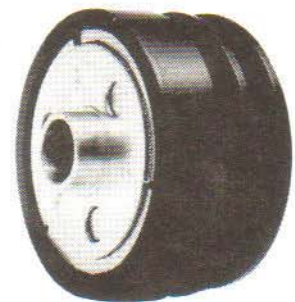

SCDP-IC

COMET® INDUSTRIES

358 N.W. "F" Street, Richmond, IN 47374-2297
(765) 966-8161 (765) 935-2346

SPECIFICATIONS

SELF CONTAINED SINGLE PULLEY (FIG. 1) SCP-IC

ORDER NO.	MODEL NO.	KEYWAY OR KEY	BORE	A	B	C	D	BELT SECTION	PITCH DIA.	
									A	B
212183A	SCPIC400AB-75	3/16 K'WAY	3/4	4"	4.07	1.88	2.56	AB	3.54	4.00
211373A	SCPIC400AB-87	3/16 KEY	7/8	4"	4.07	1.88	2.56	AB	3.54	4.00
212180A	SCPIC400AB-100	1/4 KEY	1"	4"	4.07	1.88	2.56	AB	3.54	4.00
213176A	SCPIC350AB-100	1/4 KEY	1"	4"	3.75	1.80	2.56	AB	3.23	3.69

SELF CONTAINED SINGLE PULLEY (FIG. 2) SCP-IC

ORDER NO.	MODEL NO.	KEYWAY OR KEY	BORE	A	B	C	D	BELT SECTION	PITCH DIA.	
									A	B
212177A	SCPIC550AB-75	3/16 K'WAY	3/4	4"	5.37	1.80	2.56	AB	4.85	5.31
212178A	SCPIC550AB-87	3/16 KEY	7/8	4"	5.37	1.80	2.56	AB	4.85	5.31
212179A	SCPIC550AB-100	1/4 KEY	1"	4"	5.37	1.80	2.56	AB	4.85	5.31

SELF CONTAINED DOUBLE PULLEY (FIG. 3) SCDP-IC

ORDER NO.	MODEL NO.	KEYWAY OR KEY	BORE	A	B	C	D	E	BELT SECTION	PITCH DIA.	
										A	B
212190A	SCDPIC500AB-75	3/16 K'WAY	3/4	4"	5"	1.91	2.66	3.13	AB	4.34	4.81
212186A	SCDPIC500AB-87	3/16 KEY	7/8	4"	5"	1.91	2.66	3.13	AB	4.34	4.81
212184A	SCDPIC500AB-100	1/4 KEY	1"	4"	5"	1.91	2.66	3.13	AB	4.34	4.81

FIG. 1
SELF CONTAINED SINGLE PULLEY

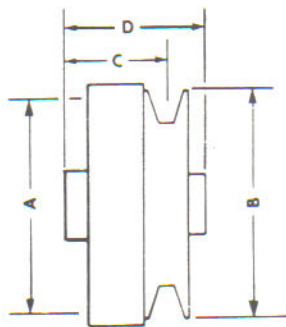

FIG. 2
SELF CONTAINED SINGLE PULLEY

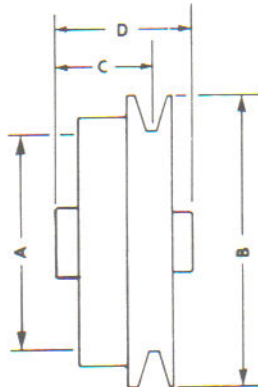

FIG. 3
SELF CONTAINED DOUBLE PULLEY

